

# NEW VALVE SHUTTER EXTENDED SWIRL

The extended valve shutter (swirl) makes it easier to close and apply valves at walls of greater depths

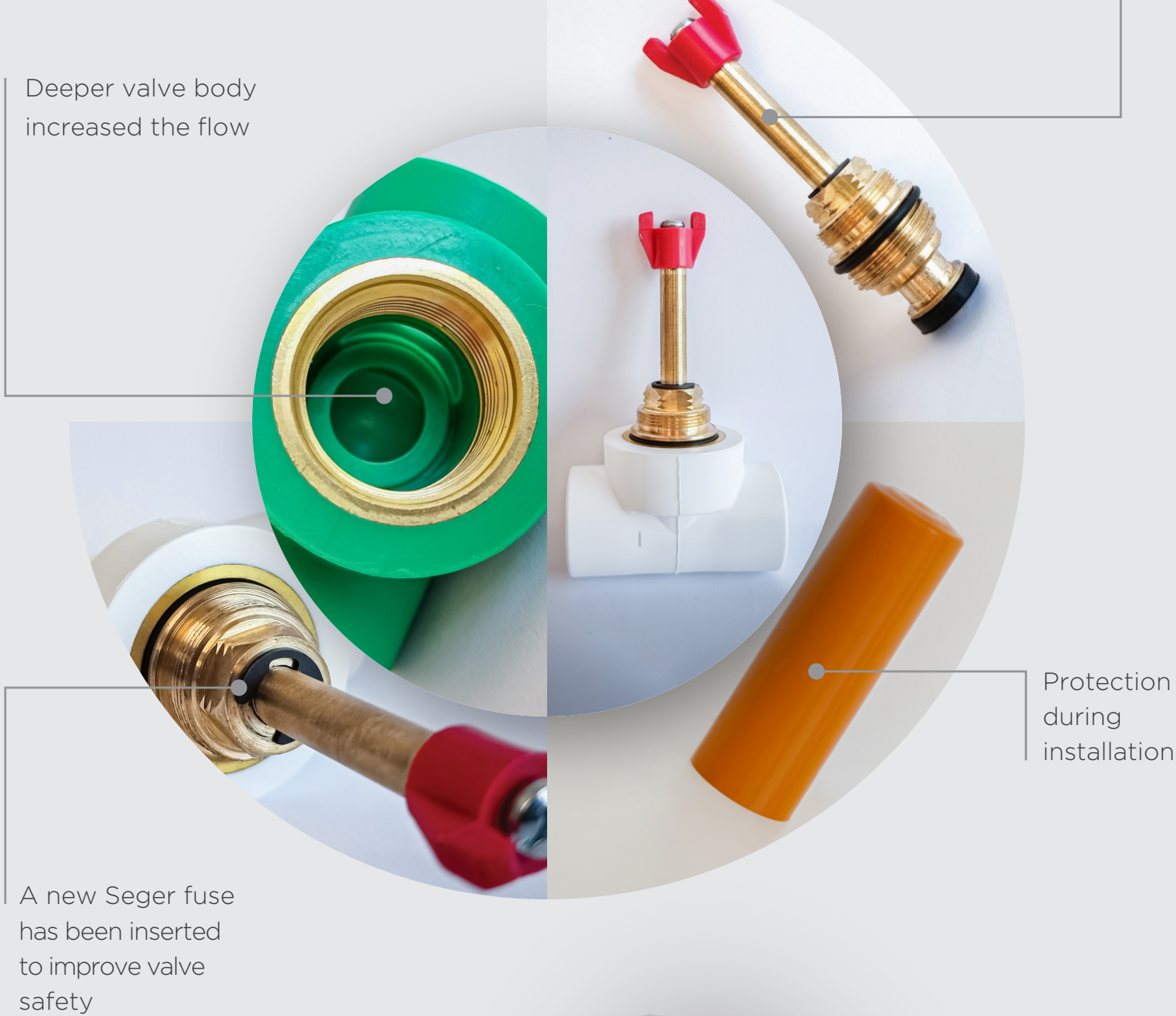

**Metal inserts** that are an integral part of the female thread and male thread fittings are made of premium brass. Valve shutter is produced according to the norms SRPS EN ISO 15874-3: 2013.

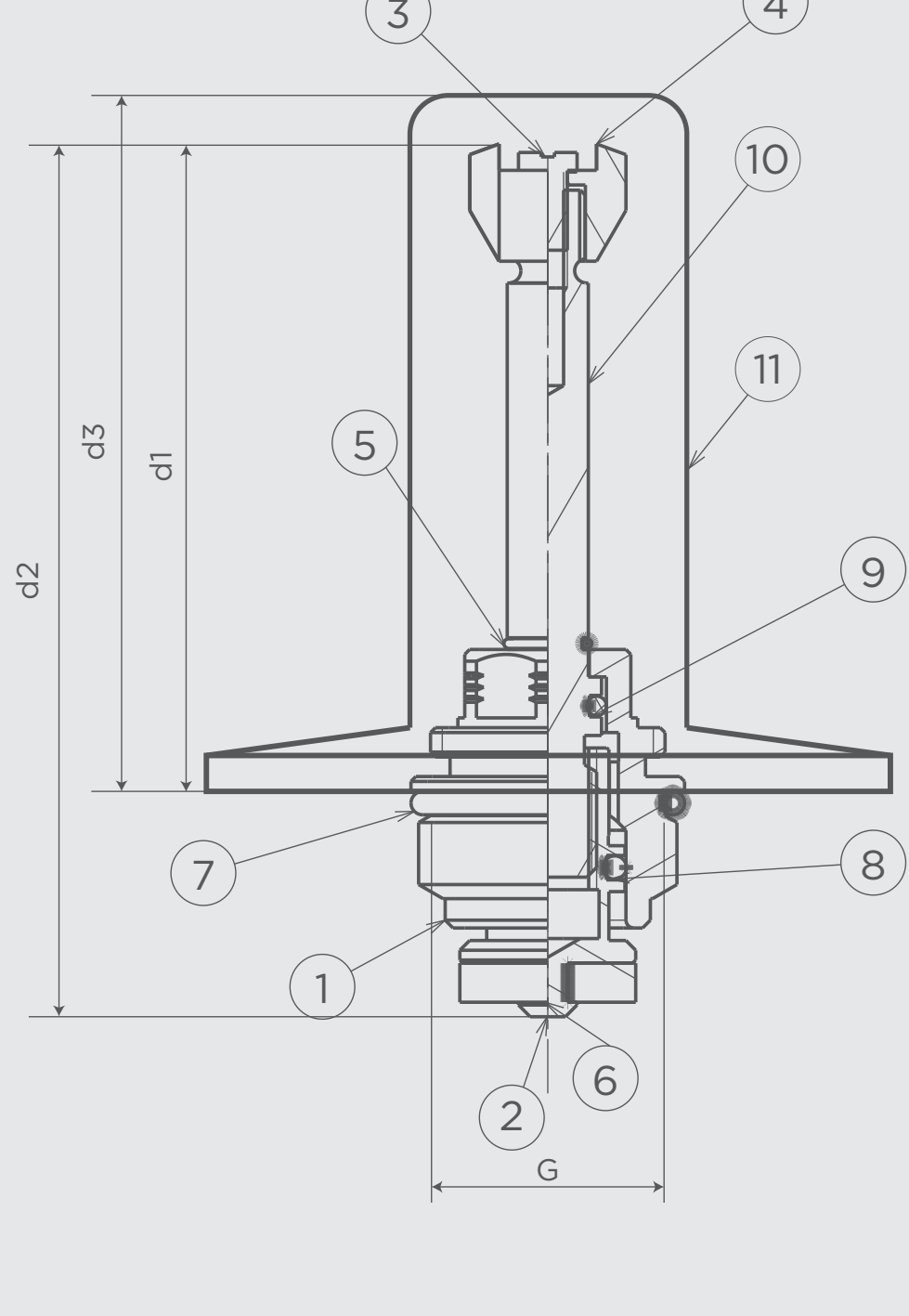

## Parts of the valve shutter

1. Guide
2. Seal carrier
3. Screw
4. Handrail
5. Fuse
6. Flat seal
7. "O" ring
8. "O" ring
9. "O" ring
10. Spindle
11. Protective cap

VALVE SHUTTER - SWIRL								
CODE			DN		d <sub>1</sub>	d <sub>2</sub>	d <sub>3</sub>	G
GREEN	WHITE	GRAY	[inc]	[mm]	[mm]	[mm]	[mm]	[mm]
10004230	10033230	10024230	1/2"	20	71.3	93	76	1/2"
10004231	10033231	10024231	3/4"	25	71.3	93	76	3/4"

